

# F2E 162B Multiplane fan

172×162×51mm



Metal Blades

## Dimensions

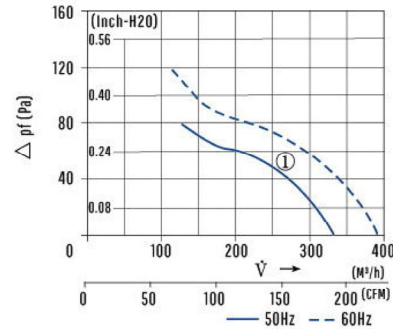
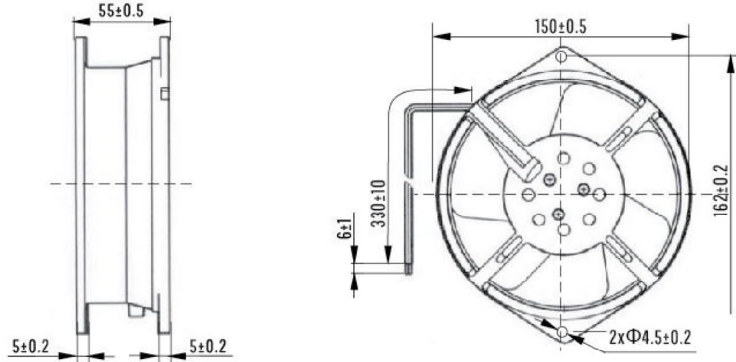

Motor Structure	Shaded pole motor.
Safety	Impedance Protected
Operation System	Dual high Precision ball bearings. (single sleeve bearing)
Allowable Ambient Temperature Range	-25~+80 °C
Insulation	F
Protection degree	IP44
Material	Aluminum alloy molding, surface silver treatment, metal plate forming, welding on motor rotor.
Impeller	Black anti-corrosion treatment, metal blades.
Bearing Type	B: Ball
Power Connection	Terminal connection

Type	F2E-162B-230	F2E-162B-115
Bearing	Ball	Ball
Rated operating voltage(V)	220-230	110-115
Rated frequency(Hz)	50/60	50/60
Rated current max.(A)	0.20-0.26	0.42-0.51
Rated Power(w)	53-43	40-35
Speed(RPM)	2700-3000	2700-3000
Wind volume(m³/h)	325-380	325-380
Noise dB(A)	48-52	48-52
Weight(g)	110g	110g