

FUSE LINKS

INDUSTRIAL CYLINDRICAL FUSE LINKS

aM INDUSTRIAL CYLINDRICAL FUSE LINKS

Cd-Pb
FREE

aM

Cylindrical fuse links aM class are intended for short circuit protection in motors, transformer and other load with high inrush currents. Excellent protection of switchgear (contactor, thermal switch) due to the good current limiting capability and low I^2t values. These fuse links must be associated to an overload device protection as a thermal switch. Made of ceramic tube with high withstand to internal pressure and thermal shock, that allow a high breaking capacity in a reduced physical space. The melting elements are silver plated in order to avoid the aging and thus keep unalterable the electric characteristics. Contacts caps are made of silver plated copper. Available versions with fusing indicator or with striker for use in fuse holders with microswitch.

INDUSTRIAL CYLINDRICAL FUSE LINKS aM

SIZE	I _n (A)	REFERENCE		U (V)	BREAKING CAPACITY (kA)	REFERENCE WITH striker	U (V)	BREAKING CAPACITY (kA)	PACKING
		WITHOUT indicator	WITH indicator						
8x31	1	411101	411201	400	20				10/100
	2	411102	411202	400	20				10/100
	4	411104	411204	400	20				10/100
	6	411106	411206	400	20				10/100
	8	411108	–	400	20				10/100
	10	411110	411210	400	20				10/100
10x38	0,16	440031	–	500	120				10/100
	0,25	440033	–	500	120				10/100
	0,5	440000	–	500	120				10/100
	1	440001	440101	500	120				10/100
	2	440002	440102	500	120				10/100
	4	440004	440104	500	120				10/100
	6	440006	440106	500	120				10/100
	8	440008	440108	500	120				10/100
	10	440010	440110	500	120				10/100
	12	440012	440112	500	120				10/100
	16	440016	440116	500	120				10/100
	20*	440020	440120	400	120				10/100
25*	440025	440125	400	120				10/100	
14x51	0,25	441031	–	690	80	–	–	–	10/50
	0,5	441000	–	690	80	–	–	–	10/50
	1	441001	441101	690	80	441201	500	120	10/50
	2	441002	441102	690	80	441202	500	120	10/50
	4	441004	441104	690	80	441204	500	120	10/50
	6	441006	441106	690	80	441206	500	120	10/50
	8	441008	441108	690	80	441208	500	120	10/50
	10	441010	441110	690	80	441210	500	120	10/50
	12	441012	441112	690	80	441212	500	120	10/50
	16	441016	441116	690	80	441216	500	120	10/50
	20	441020	441120	690	80	441220	500	120	10/50
	25	441025	441125	690	80	441225	500	120	10/50
	32	441032	441132	500	120	441232	500	120	10/50
	40	441040	441140	500	120	441240	500	120	10/50
45	441045	441145	500	120	441245	400	120	10/50	
50*	441050	441150	400	120	441250	400	120	10/50	

(*) Overrating fuses

STANDARDS

IEC 60269-1
IEC 60269-2
EN 60269-1
EN 60269-2

DIMENSIONS

23

I_t AND CUT-OFF CHARACTERISTICS

28

Pt CHARACTERISTICS AND POWER DISSIPATION

29

22



411102



440001



441140

FUSE LINKS

INDUSTRIAL CYLINDRICAL FUSE LINKS

aM INDUSTRIAL CYLINDRICAL FUSE LINKS
NEUTRAL LINKS
gG/aM DIMENSIONS

Cd-Pb
FREE

aM



FUSE LINKS

INDUSTRIAL CYLINDRICAL FUSE LINKS aM

SIZE	I _n (A)	REFERENCE		U BREAKING CAPACITY		REFERENCE		U BREAKING CAPACITY		PACKING
		WITHOUT indicator	WITH indicator	(V)	(kA)	WITH striker	(V)	(kA)		
22x58	2	442002	442102	690	80	442202	690	80	10/50	
	4	442004	442104	690	80	442204	690	80	10/50	
	6	442006	442106	690	80	442206	690	80	10/50	
	8	442008	442108	690	80	442208	690	80	10/50	
	10	442010	442110	690	80	442210	690	80	10/50	
	12	442012	442112	690	80	442212	690	80	10/50	
	16	442016	442116	690	80	442216	690	80	10/50	
	20	442020	442120	690	80	442220	690	80	10/50	
	25	442025	442125	690	80	442225	690	80	10/50	
	32	442032	442132	690	80	442232	690	80	10/50	
	40	442040	442140	690	80	442240	690	80	10/50	
	50	442050	442150	690	80	442250	690	80	10/50	
	63	442063	442163	690	80	442263	690	80	10/50	
	80	442080	442180	500	120	442280	500	120	10/50	
	100	442000	442100	500	120	442200	500	120	10/50	
125*	442015	442115	400	120	442215	400	120	10/50		



442063

(*) Overtating fuses

NEUTRAL LINKS

SIZE	I _n (A)	REFERENCE	PACKING
8x31	N	430000	10/100
10x38	N	431000	10/100
14x51	N	432000	10/50
22x58	N	433000	10/50



430000

DIMENSIONS

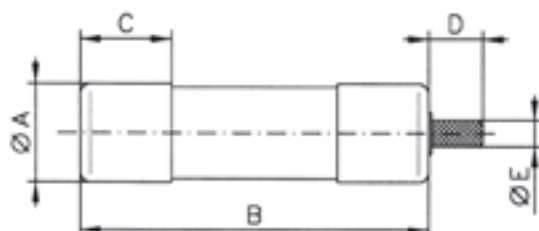

SIZE	A	B	C	D	E
8,5x31,5	8,5	31,5	6,3	–	–
10,3x38	10,3	38	10	–	–
14,3x51	14,3	51	13	8	4
22,2x58	22,2	58	16	8	4

STANDARDS

IEC 60269-1
IEC 60269-2
EN 60269-1
EN 60269-2

I_t AND CUT-OFF CHARACTERISTICS

28

P_t CHARACTERISTICS AND POWER DISSIPATION

29

23